

OMEGA
ELEVATOR

Model MQC



The elevator that optimizes space and energy

*Specially designed to be installed
in existing buildings with reduced
spaces, in both shaft and pit dimen-
sions*

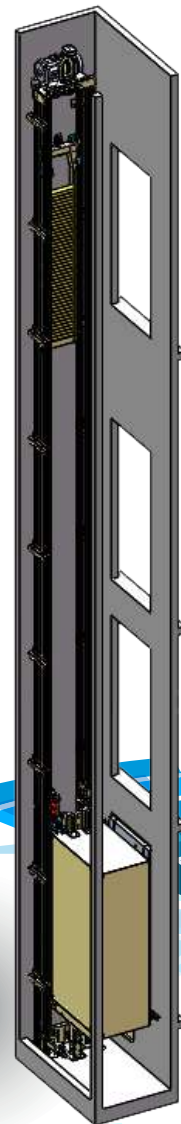



The tailor-made solution

Maximum flexibility and performance

Main characteristics

Load (kg)	320 / 375 / 450 / 525 / 630 kg		4 / 5 / 6 / 7 / 8 persons
Speed	1,00 m/s		
Travel	Up to 50 meters		
Stops	Up to 16 stops		
Shipments	Single entrance Two entrance 180° Two entrance 90° Triple boarding		
Conditioning system	Electric suspension 1:1		
Maneuver	VVVF controlled by electronic board		
Door types	2H and 3H telescopic opening automatic		Swing or semi-automatic
Free passage of doors	700 / 800 / 900 mm (standard)		600 / 650 / 700 / 750 / 800
Door clearance	2.000 / 2.100 mm		2.000 mm
Cabin dimensions	Customized according to project		
Interior cabin height	2.100 mm 2.200 mm		
Feeding	380 (3 ~) 220 (1 ~)		

Technological advantages

ECO DESIGN



- Use of gearless motor with permanent magnets without gears or oils; as well as VVVF technology for control
- Timed cab light shutdown
- Low acoustic impact
- Significant reduction in operating costs
- Possibility of accumulating and regenerating energy
- Possibility of single-phase execution

CONFORT



- Soft, comfortable and quiet movements for the user
- Starts and stops are progressive and precisely
- Significant reduction in noise in the electrical cabinet as a result of the elimination of contactors

SAFETY



- Rescue system and automatic evacuation of the user in case of power failure
- Bidirectional communication system in the cabin
- Protection of passengers by means of infrared curtains when entering the cabin

OPTIMIZATION



- Achieving maximum cabin dimensions in minimum gaps
- Allowing execution in single, double and triple boarding
- The building will have a greater usable surface for architects, developers and end users



Standard Dimensions

Simple boarding (very narrow gap) - Mechanics in the background

LOAD (KG)	PERSONS	CABIN	SHIPMENT	HOLE	DOOR	PIT EN 81-20	FLIGHT	PIT EN 81-21	FLIGHT
225	3	630 x 1.230	Simple	780 x 1.800	SEMI-650	1.200	3.600	450	3.600
320	4	680 x 1.230	Simple	850 x 1.800	SEMI-700	1.200	3.600	450	3.600
375	5	850 x 1.230	Simple	1.000 x 1.800	SEMI-800	1.200	3.600	450	3.600
450	6	1.000 x 1.250	Simple	1.130 x 1.870	AT3H-700	1.200	3.600	450	3.600
630	8	1.100 x 1.400	Simple	1.250 x 2.000	AT3H-800	1.200	3.600	450	3.600

1.- The cabin dimensions are configurable depending on the existing gap

Double Boarding 90 - Lateral Mechanics

KG	PERSONS	CABIN	SHIPMENT	HOLE	DOOR	PIT EN 81-20	FLIGHT	PIT EN 81-21	FLIGHT
375	5	950 x 1.150	2 x 90°	1.570 x 1.400	AT2H-700	1.200	3.600	450	3.600
450	6	1.000 x 1.200	2 x 90°	1.610 x 1.500	AT2H-800	1.200	3.600	450	3.600
630	8	1.100 x 1.400	2 x 90°	1.770 x 1.860	AT2H-900	1.200	3.600	450	3.600
630	8	1.250 x 1.250	2 x 90°	1.860 x 1.650	AT2H-900	1.200	3.600	450	3.600

Triple Boarding

KG	PERSONS	CABIN	SHIPMENT	HOLE	DOOR	PIT EN 81-20	FLIGHT	PIT EN 81-21	FLIGHT
455	6	1.100 x 1.100	2 x 90°	1.620 x 1.700	AT2H-800	1.200	3.600	450	3.600

Setting

Simple Boarding
(mechanical in the background)

Double Boarding 90°

Double Boarding 180°
(lateral mechanics)

Vertical Section

AH : Gap width
 FH : Hollow bottom
 AC : Cabin width
 FC : Cabin bottom
 PL : Free way



More about the MQC Model

Regulations	The lift complies with :		
	European Directive of lifts 2014/33/UE	EN 81-20	EN81-50
	EN 81-21	EN 81-28	EN 81-70
	EN 12015	EN 12016	
Conditions	Operating		
	Temperature range	of 5-40° in the machinery space according to (EN81-20:2014)	
	Humidity	up to 95%	
Performance			
	Capacity	125% of rated load	
	Stopping accuracy	+/- 5 mm	
	Acceleration	0,5 m/s²	
	Deceleration	0,5 m/s²	
	Noise level	less than 45dB on landing	
	Start frequency	120 - 180 starts / hour	

ROPPING

- Ropping 1:1

MACHINE

- GEARLESS synchronous permanent magnets machine
- Low energetic consumption
- Does not use oil
- Soft running and low noise (45 dB)
- Reduced diameter sheaves 210 mm.
- Hardened traction pulley HRC50
- 380V-3 phases (also available in 220 V-1F)

BRAKE

- Of double effect according to EN 81-20:2014

ENCODER

- Absolute encoder BISS-C
- Absolute encoder Endat 1313





Optional

TIMER CAR LIGHT



The turning off the car light can be timed so that after a certain time, an there is an auto-matic shut-off

MECHANICAL LOCK DEVICE



This is a device that allows the locking of landing doors preventing its opening, unless the car door and the landing door are facing

SELECTIVE OPENING OF DOORS

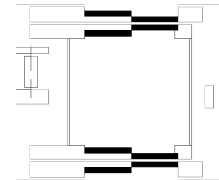

Option that allows lift cabins having double entrance on the same floor, to configure the door you want to be open

FIRE ALARM



When the switch fire or fire sensors are activated, the elevator will return to the designated floor, opening doors and allowing the release of all passengers. All existing calls will be canceled and the elevator will be out of service (according to standard EN 81-73)

FIRE ALARM



In addition to the fire emergency, the elevator allows it to be used by firefighters to evacuate people. For this, they have a panel for exclusive use that allows the elevator to move using keys and as long as the emergency fire alarm has been activated

EARTHQUAKE ALARM



When the seismic sensor is activated, the cabin will stop at the next floor, will open doors and remain still with open doors

AUTOTRANSFORMER



Electrical device that increases the input voltage, maintaining power. It is used to feed 380 V/3F engines or motors when the voltage is 208 V/3F or 220 V/3F

REDUCED PIT KIT



It is used when it is impossible, for architectural or other issues, to obtain a regulatory pit for maintenance by qualified personnel. It is consists of:
Mechanical stop / System for detecting people in pit / Retractable spoiler with safety contact

REDUCED HEADROOM KIT

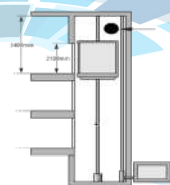

It is used when it is not possible to obtain superior security space on top of the shaft (headroom). It is consists of:
Mechanical stop / System for detecting people on ceiling



OMEGA
ELEVATOR

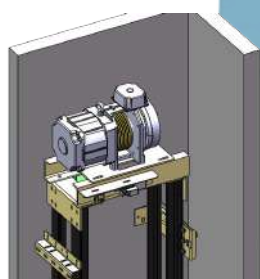

FLIGHT

OMEGA ELEVATOR

Polígono Industrial de Júndiz
C/ Júndiz, 29
01015 VITORIA-GASTEIZ
(Spain)

Phone : +34 945 290 308

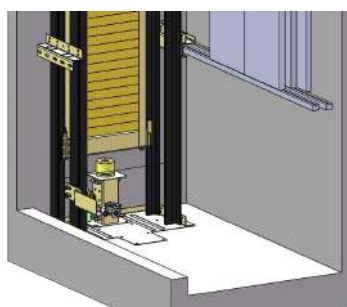

PIT



COUNTERWEIGHT
CHASSIS

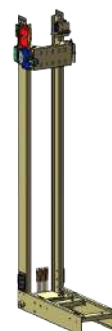

CAB CHASSIS



www.omegaelevator.com

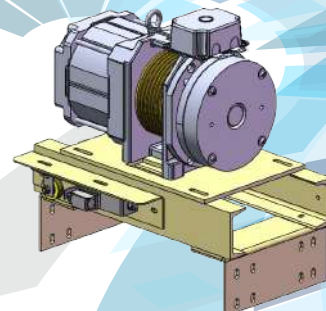

BENCH